



SESSION 2

FINDING YOUR WAY AROUND YOUR
NEW SCHOOL

SECONDARY SCHOOL SUBJECTS

DISCUSS - DO YOU AGREE WITH THE FOLLOWING STATEMENTS?

- Older students will trick you if you ask for help
- If you get lost you should stand in the corridor and wait for someone to come and find you
- Teachers will shout at you if you ask them to help you
- You should always follow everyone else, you will find your way eventually

This is the map of a secondary school in Enfield

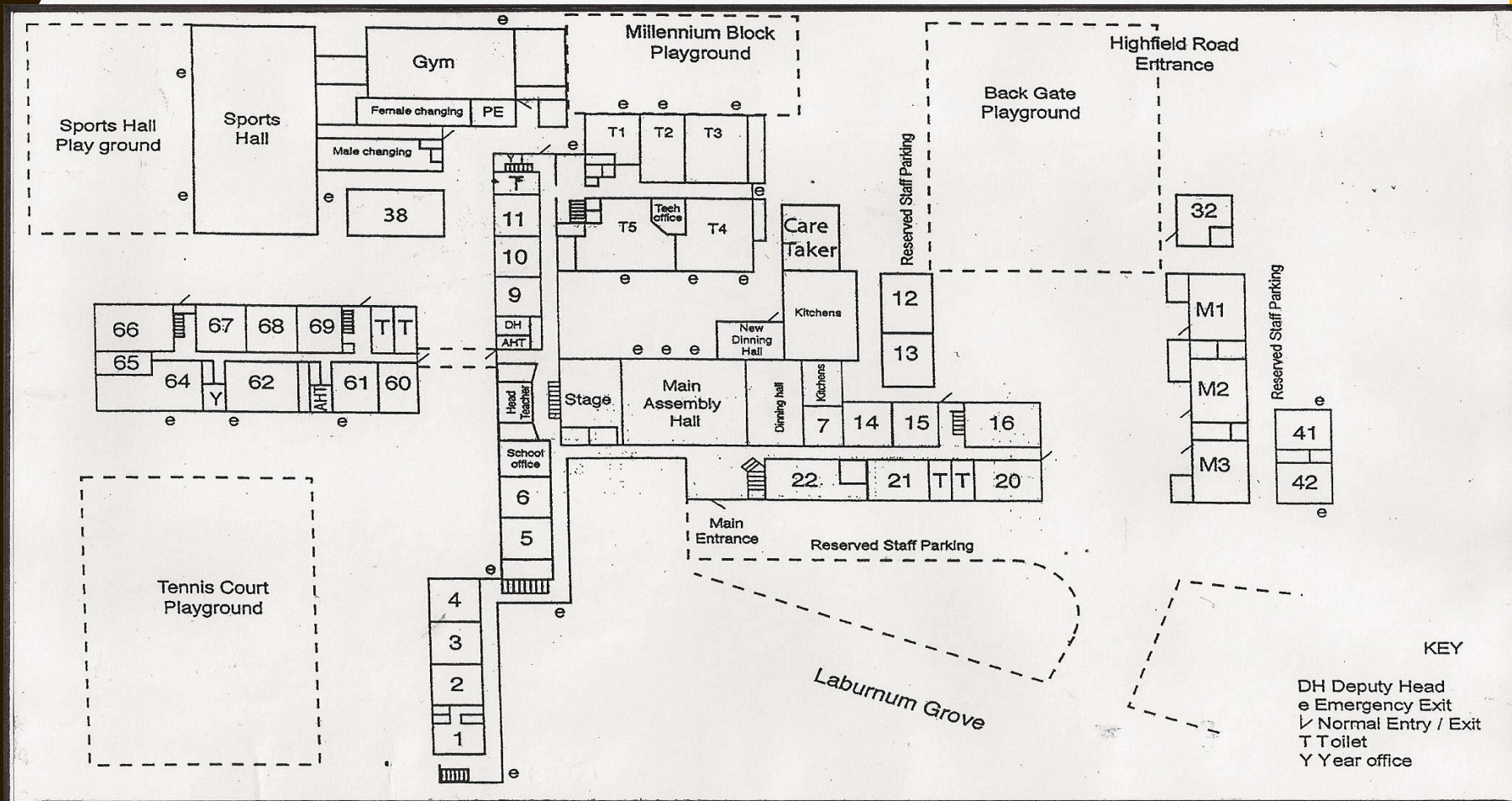

Use the instructions on the next slide to find out the different class rooms you will need to go to throughout the day. If you can, print the map off and highlight the rooms in different colours. If not just see if you can find all the different rooms.

MAP WORK

- You go straight to registration in your form room – room 62.
- After registration you have maths in room 11.
- Next you have technology in T4.
- After technology, you go to a special year assembly in the hall.
- Hurrah, it's break time and you meet your friends on the back gate playground.
- After break you have English in room 22.
- Then you have French in room 1.
- Lunchtime, and you meet your friends in the dining hall.
- After lunch you go back to your form room for registration (can you remember which room? - room 62).
- Then it is PE so you need to make your way to the changing rooms.
- Home time, and you wait for your friends by the Highfield Road entrance.



DISCUSS - **SECONDARY SCHOOL SUBJECTS**

- What are your favourite school subjects?
- What new subjects do you think you will have in secondary school?
- What equipment will you need?